

RIBA 

Chartered Practice



HEALTHCARE
ARCHITECTURE

richard eves ARCHITECTS

HEALTHCARE
ARCHITECTURE

■ richard eves **ARCHITECTS**

PRACTICE PROFILE

The practice has a rich history as the business has existed for over 100 years, making us one of the longest practicing Architectural firms in the region. Following Richard's retirement in 1990, Peter Eves and Ian Moore took over the running of the business and they have continued to develop expertise in the design of healthcare facilities. Over the last 30 years, Richard Eves Architects have worked with numerous NHS Trusts across the UK to provide our expertise in healthcare design. Work on community projects and the Education resources, both locally and across the UK alongside ecclesiastical and domestic projects has created an exciting and inspiring portfolio of work.

The healthcare sector is changing radically. Advances in medical science and technology, together with an ageing population, are having a dramatic effect on the building types required. We pride ourselves on our design led approach to delivering innovative, efficient and user-friendly spaces that meet the brief for users, consultants and carers. In recent years, we have developed a particular expertise in the area of both residential and outpatient mental health facilities. Our work has led to an improvement in coping skills and the relationships of the patients as well as providing safe and comfortable environments for recovery.

John Leeson and Andrew Staunton are the new generation in the office and together we are looking to the future. We offer our clients the advantage of working with Building Information Modelling (BIM) software and have already seen how 3D renders and imagery of schemes can transform the way in which we communicate our ideas to clients, other consultants, local authorities and contractors. These new technologies together with our traditional skill sets allow us to communicate our designs and aspirations so that we can help you, the client, to achieve your goals and ambitions on both current and future projects.



CROSS LANE HOSPITAL SCARBOROUGH

Cross Lane Hospital in Scarborough involved the demolition of the majority of the existing buildings on the site and construction of a new build hospital for older people suffering from dementia, offices for the local Trust staff, and a physiotherapy department.

In phase two we extended the existing Ayckbourn Unit to provide male and female inpatient accommodation for Adult Services, including a new reception area and staff facilities. The completed areas were built around secure landscaped gardens and courtyards.





PRINCESS ROAD CLINIC MALTON

The existing offices on the Princess Road Clinic site were demolished allowing us to provide a new two-storey purpose-built day clinic and office building for Mental Health Services in the Malton area. The Kingspan SIPS prefabricated panelling system provided the main structure, clad in brick, render and timber boarding with a slate roof.





SPRINGWOOD COMPLEX MALTON

The new Springwood Unit was built on the Malton Hospital site following the demolition of the existing building. The new unit provided inpatient accommodation for older people requiring complex care and included new en suite bedroom accommodation, day spaces and staff facilities.





PEPPERMILL COURT YORK

In the summer of 2015 the Care Quality Commission closed Bootham Hospital, Tees Esk & Wear Valleys' main inpatient facility for Adults & Older People's Services in York. Whilst the Trust had planned for a new unit in the future, the requirement for accommodation for those patients using the Services at that time and displaced by the closure, created an urgent need for temporary facilities.

We were appointed as Architects for the refurbishment of Peppermill Court, a vacant building in the York portfolio, with work starting on site in the autumn of 2015 on the basis of a negotiated contract with HACS Construction Ltd. The scheme was completed allowing patients to return to the new unit in the summer of 2016.



THE ORCHARDS RIPON

The original Orchards Building in Ripon was designed by Richard Eves Architects as a Community Unit for the elderly in the early 1990s. Over the years the use of the building had changed several times and towards the end of 2012 we were asked by Tees Esk & Wear Valleys NHS Foundation Trust to work on the refurbishment and extension of the building to provide residential and office accommodation for Adult Mental Health Services in the Harrogate district area. Built on an area of gypsum faults, typical of that part of Ripon, the scheme, which included significant rebuilding and extension, was complicated and, at times, tortuous. However, the completed scheme, which remodelled the original and included a complementary landscaping scheme, was welcomed by both the users and visitors who came to the building.





WORSLEY HUB SELBY

The new Worsley Court building will provide outpatient clinic facilities for Children and Adolescent and Adult and Older People's services in the Selby area. This state-of-the-art 21st century facility will include new open plan offices for all locality Services staff, meeting and training rooms and break-out spaces.

Subject to final approval, the building is due on site in 2019 with completion early in 2020.



BUILDING INFORMATION MODELLING (BIM)

Richard Eves Architects continues to aim to be at the forefront of technology advancement and have recently made the transition to adopting BIM technologies. Building Information Modelling (BIM) is more than a new technology; it is an innovative approach to the entire design, construction, and maintenance process. This technology provides the practice with the ability to operate more productively and produce higher-quality work. BIM allows us to create and review multiple design scenarios and convey clearly understandable options to the client.

From our client's perspective BIM provides better co-ordination and collaboration with other consultants, conflict detection and risk mitigation, high levels of customization and flexibility, schedules and costings from a much earlier stage and maintenance and building life cycle projections. BIM offers the promise of a high-quality project, as well as time and cost savings. The 3D models enable our clients to gain a better understanding, early in the design process, of how their final project will look.

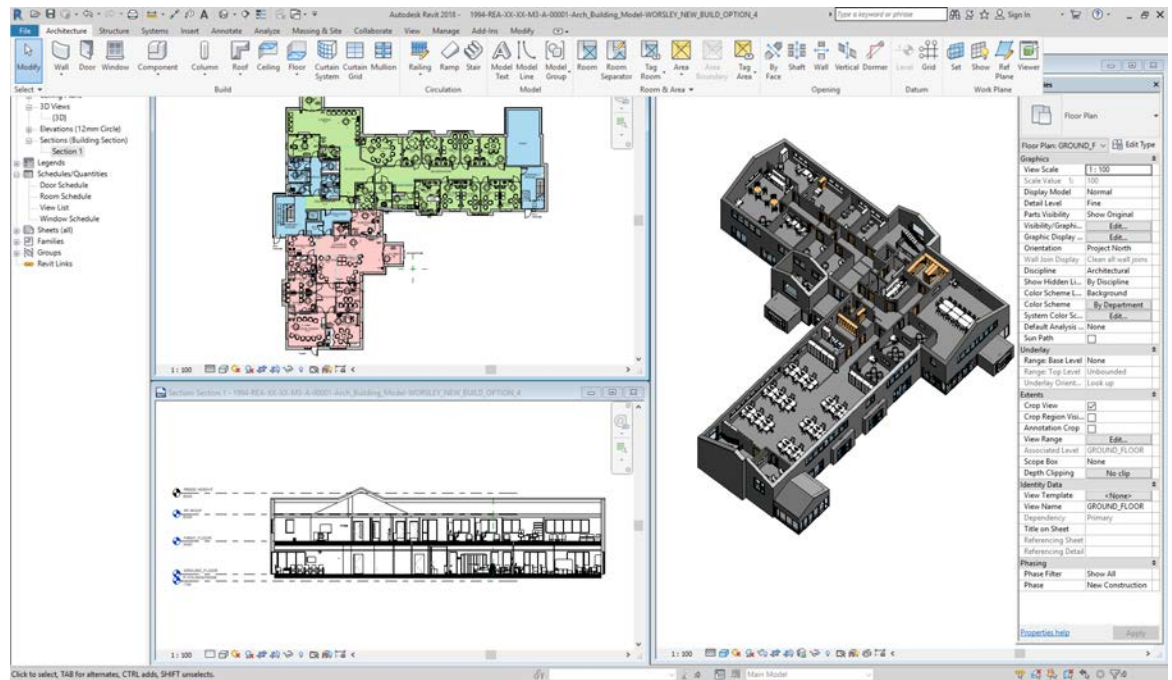

GET IN TOUCH

ALEXANDRA VILLA
3 VICTORIA AVENUE
HARROGATE
HG1 1EQ

E: office@rearchitects.co.uk
T: 01423 504488
W: www.richardevesarchitects.co.uk





No stopping
except buses